

The Family Tree

The Newsletter of the Sauvage /Sowash /Soash Family

Web site <http://www.feist.com/~rsoash/soash.html>

March 2001

Vol. 14, No. 1

2001 SAUVAGE / SOWASH / SOASH FAMILY REUNION

July 19 - 22, 2001

Reading, Pennsylvania

The 2001 SAUVAGE / SOWASH / SOASH FAMILY REUNION will be held July 19-22, 2001, in Reading, Pennsylvania, with Merwin and Peggy Soash as hosts.

A block of rooms has been reserved at Lincoln Plaza Hotel & Conference Center, 100 N. 5th Street, Reading PA 19601. Room options include 1 king bed or 2 double beds (single or double occupancy, \$84; 2 double beds suite with pullout sofa bed & large full bath, \$125; Queen size bed with pullout sofa bed, jacuzzi & full bath, \$130. Prices do not include state and local taxes. All rooms include the breakfast buffet and covered parking. Make your hotel reservations by phone 800-372-3710 or 610-372-3700 by Monday June 18 and request the Soash/Sowash/Sauvage Reunion discount rates.

Area websites: Lincoln Plaza Hotel - www.lincolnplaza.com

City of Reading - www.readingberkspa.com.

Reunion Info – www.feist.com/~rsoash/soash.html

Tentative Reunion Plans - Check the website or the hotel lobby on arrival for a final schedule.

Friday, July 20 - Historical Day

8:30 – Meet in hotel lobby to caravan to the Dryville area.

9:00 – Dedication of the monument in memory of Johannes and Susanna Sauvage, the original immigrants to America, on the land that they purchased in 1743. The monument is located on the site of a vacated cemetery where they were probably buried. Johannes and Susanna came to America aboard the Winter Galley, arriving in Philadelphia in September 1738. Johannes purchased a tract of land in Berks County in 1743. This tract is nearly identical in size and shape today as in 1743 when Johannes purchased it, and it still remains a farm.

10:30 – Visit to Christ Evangelical Lutheran Church (formerly Mertz Church), 16 Fleetwood Road, Dryville where we will be able to see the original church book recording the marriage of Henry Sowash and Anna Esther Schneider on 27 Nov 1749. Henry was the only proven son of Johannes and the ancestor of nearly all Sowash / Soash families in America today. We will hear a brief history of the early Mertz Church.

Lunch on your own.

2:00 - Visit the Berks County Courthouse, 633 Court Street, Reading. We will be able to see the original 1761 German and English wills of Johannes Sauvage as well as the estate papers and the inventory of his estate. As Johannes could not write, he made his mark on the wills.

3:30 – Berks County Historical Society, 940 Centre Avenue, Reading. Barbara Goda will give a presentation about what life was like in early Berks County from the 1740's to the American Revolution, when most of the family moved on to Westmoreland County Pennsylvania. If anyone is interested in visiting Westmoreland County sites on the way, please contact Richard for a list of information.

Dinner on your own. There are a variety of restaurants in the hotel area.

Saturday, July 21 –Lancaster County Pennsylvania Dutch Visit

Departure time to be announced. We'll make stops at Landis Valley Museum, The People's Place or the Plain and Fancy Farm, Kitchen Kettle Village or Strasburg. All of this includes living history from 1750, Amish food, arts and crafts demos, railroading, shopping. If there is enough interest, we will arrange a bus tour rather than trying to caravan.

6:30 p.m. Banquet and Business Meeting

Buffet in the Lincoln Plaza Hotel. Entrees of broiled chicken, baked haddock or flounder, and vegetable lasagna. \$33 per person including gratuity & sales tax. The business meeting will include a discussion of future plans for the family association.

For additional reunion information, contact Merwin Soash, 2 Ridgway Dr, Chadds Ford, PA 19317-9398 (phone 610 388-2461 - email Soash1M@aol.com) or Richard Soash (note new address), 11614 W Dora Court, Wichita, KS 67209 (phone 316 729-6591 – email rsoash@feist.com). You may also check the website at <http://www.feist.com/~rsoash/reunion.htm> for current information.

Thanks to the following for their generous donations to the Cemetery Fund:

**Maurine & Richard Glantz (2E4C1E)
Lorraine Soash in memory of Paul Soash (1B7E2)
Elizabeth Walter (2C7A1A1)**

A special thanks to Jonelle Sowash (1J7G1/W/) for her generous donation

We still need additional funds to pay for the monument for Johannes and Susanna Sauvage.
Your donations help make such projects possible.

The Johannes & Susanna Sauvage Monument

Allen Silfies, a local mason, will be constructing the monument to honor Johannes & Susanna Sauvage. The monument will be about 5 feet high by 4 feet wide by 4 feet deep, constructed of local fieldstones, with a granite marker embedded. The original suggestion was to use a large boulder from the area and attach a bronze marker. However, no suitable boulder was found, and bronze markers are popular targets for thieves. The fieldstone monument should provide a durable and attractive monument. Below is the inscription for the granite marker to be imbedded in the monument.

**In honor of Johannes H. Sauvage (1698? – 1761)
& his wife Susanna
Arrived Philadelphia, PA 05 Sept 1738
Purchased this land 20 March 1743
Probably buried at this site in the cemetery vacated in 1863**

Erected by the Sauvage/Sowash/Soash Family Association 2001

Berks County Land of Johannes Sauvage

Original Land Tract 1743

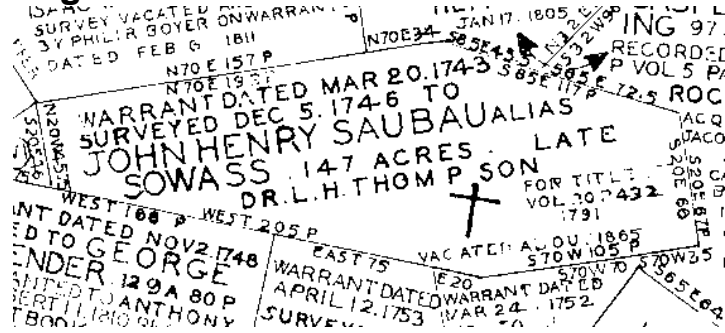

Present Day Land Tract

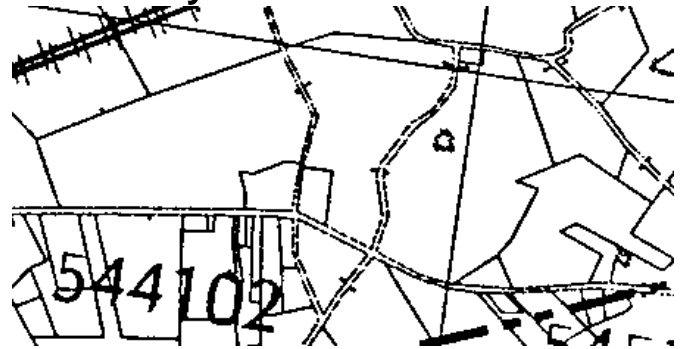

Reservations

Friday Historical Day

Please list names of guests attending:

Saturday Bus Trip

_____ persons @ \$30 deposit per person \$_____

If we have enough interest, we will hire a bus for the trip. If we have a smaller group, we will rent vans to provide transportation. We will refund any money not used and request additional funds if the tour is more expensive. The deposit may not cover entrance fees to some of the sites on the tour.

Please list names of guests attending:

Saturday Night Buffet

_____ persons @ \$33 per person \$_____

Please list names of guests attending:

Donations to Cemetery Fund for Johannes & Susanna Sauvage \$_____

Family Dues - \$10 per year \$_____

If your mailing label has M01 or M02, your dues are paid.

Please return checks and this reservation slip to Richard Soash, 11614 W. Dora Court, Wichita, KS 67209 **by May 1, 2001.**